

ProDispense™

Accurately and quickly dispense preset amounts of oil, grease, water and other industrial fluids



Flexible configurations, flexible locations

Whether managing one fluid or up to eight, operating from hazardous or non-hazardous locations, ProDispense gives you total control

A consistent dispense

- Deliver the exact volume of fluid every time
- Dispense one fluid or multiple fluids at a time

Multiple dispense options

- Station (manual) mode: Dispense activated by the operator
- Recipe (automatic) mode: The recipe controls the order and amount of fluid dispensed
- Combination dispense: The recipe includes automatic and station mode dispense

Wide dispense range

- 10 cc to hundreds of gallons dispensed with an accuracy of ± 1 percent or less

Easy Integration

- Local and integrated control
- Connects to PLC and barcode scanners
- Network data collection



Flexible configurations

- Each fluid control module (FCM) manages two fluid panels
- The system manages up to eight fluids



Flexible location

- A wired remote operator station for activation in non-hazardous locations
- A wireless remote operator station for activation in hazardous locations



Fluid panels designed for a variety of materials

Seven fluid panel configurations allow for a wide range of materials, viscosities and flow rates



G3000 meter fluid panel
for grease and paint



Oil meter fluid panel
for lubricants and oil



Helical gear meter fluid panel
for high viscosity fluids

Vehicle fluid dispense

- Oil
- Brake fluid
- Coolant
- Power steering fluid
- Transmission fluid
- Windshield washer fluid

Dispense applications

- Paint/solvent
- Grease
- Hydraulic fluids
- Injection mould release
- Dye injection
- Adhesives

Fast and accurate dispensing

Graco's ProDispense is a cost effective and user-friendly electronic system that dispenses preset amounts of fluids. The ProDispense system allows durable goods manufacturers to quickly and accurately fill cavities with oil, grease, water, or other industrial fluids in assembly line environments where accurate dispensing is essential. ProDispense can deliver up to eight different fluids at multiple dispense points, accurately measure volume, track material usage and report results in either non-hazardous or hazardous areas.

Operating precision

The user interface provides for simple operation and data entry. Each dispense will deliver the correct fluid volume or the system will issue an alarm.

- A full colour display shows the dispense status
- The progress of each fluid and overall recipe dispense
- Recipes programmed to a specific fluid, volume target and dispense order



Advanced Display Module (ADM)

# Fluid	Target	Tolerance	Timeout	Order
1	0.50 gal	2 %	0 sec	1
2	100 cc	1 %	0 sec	2
3	60 sec	0 %	0 sec	3
4	250 cc	1 %	0 sec	4
5	0 sec	0 %	0 sec	5

Dispense recipes flexibility

- Up to 50 dispense recipes
- Up to 10 items per recipe, including a specific fluid and timed dispense pause

Date	Time	Location	Job ID	Volume
06/02/17	09:24	IPD Lab	00171	3 3 800 cc
06/02/17	09:24		00171	3 2 501 cc
06/02/17	09:23		1236589g	00170 0 1 151 cc
06/02/17	09:18	IPD Lab	00169	2 3 500 cc
06/02/17	09:18		00169	2 2 804 cc
06/02/17	09:18		1236589g	00169 2 1 501 cc
06/02/17	09:13	IPD Lab	00168	2 3 100 cc
06/02/17	09:13		00168	2 2 151 cc
06/02/17	09:13		1236589g	00168 2 1 104 cc
06/01/17	14:56	IPD Lab	00167	3 3 100 cc

Material Tracking

- Each dispense key data is recorded with date and time stamp
- Reporting capability tracks volume, usage and dispense results for process verification
- Job logs and error reports can be seen on screen or downloaded to USB memory

Operating ProDispense from a remote location

In Recipe mode only

With the optional Wireless Start/Stop switch, an operator can activate ProDispense in a hazardous location, like a spray booth. This allows fluid panels to remain separate in a non-hazardous area – without wired connections to the Start/Stop switch.

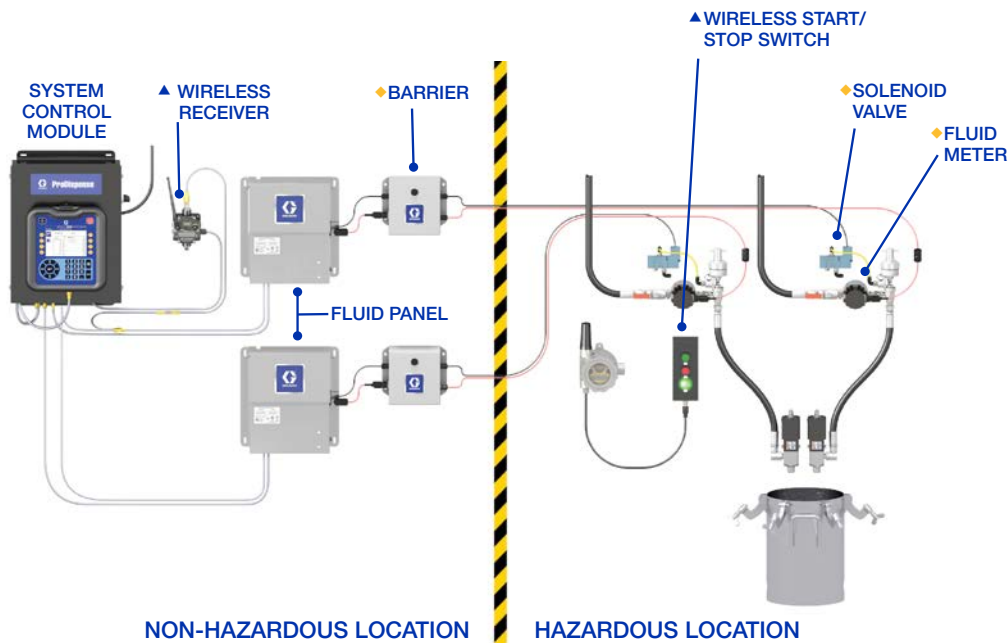

▲ The wireless Start/Stop switch is easy to install. It is intrinsically safe and needs no explosion-proof conduit or wiring within the hazardous area.

◆ For a more accurate small volume dispense in a hazardous area, use the intrinsically safe power barrier to enable installation of fluid metres and solenoid valves within the hazardous area.

In Recipe mode or Individual Station Dispense mode

Using the optional wired Start/Stop switch, ProDispense can be activated remotely by an operator in a non-hazardous area.

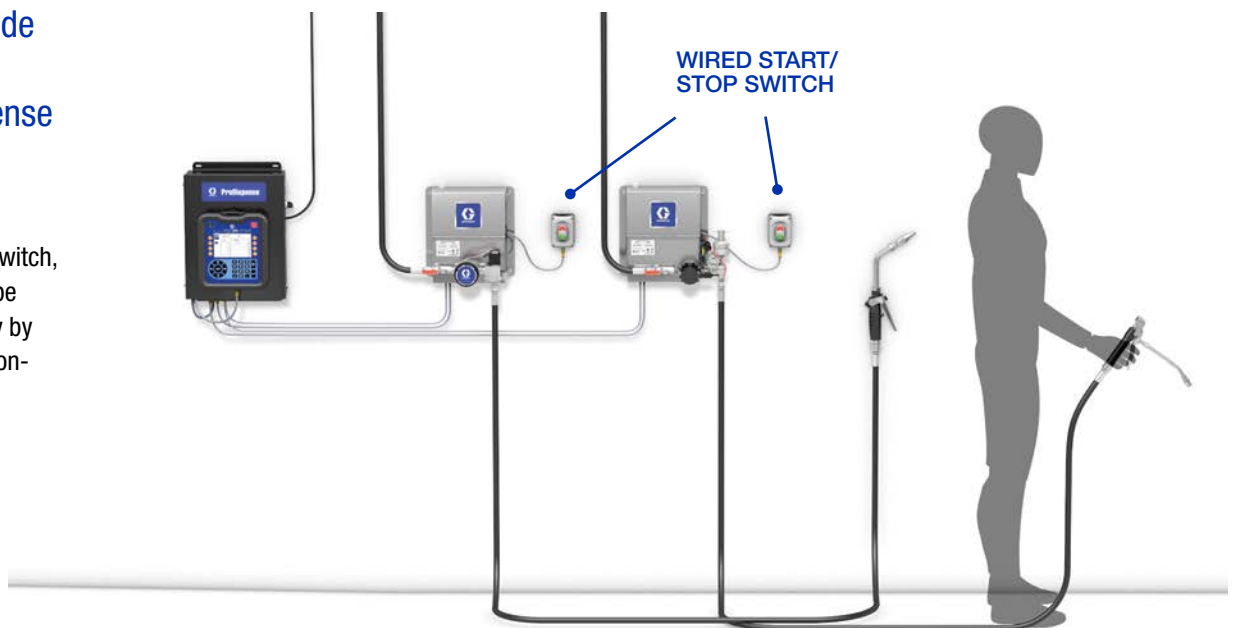

NON-HAZARDOUS LOCATION

Integration for Remote Control

Programmable Logic Controller (PLC) - for remote control, system set up and monitoring, and data reporting. Connect with ProDispense through Graco's Gateway Module.*

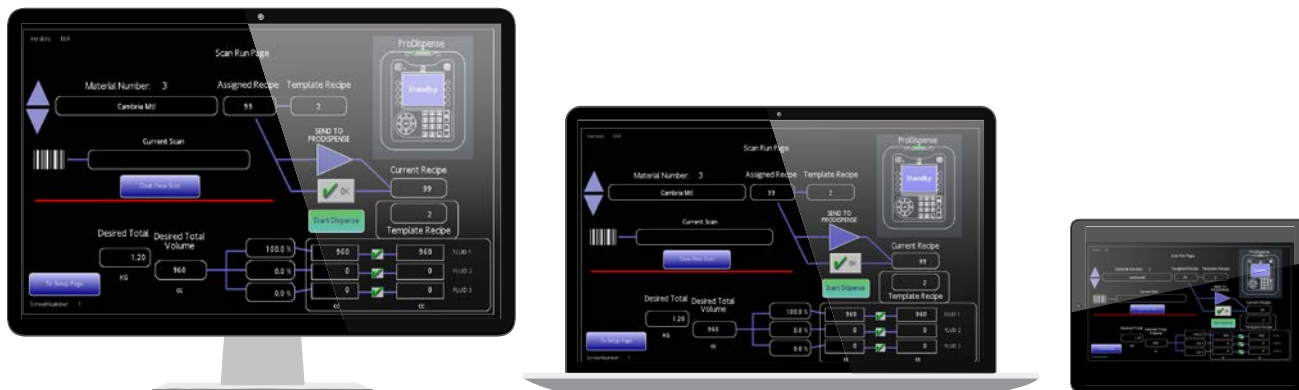

Peripheral devices (PC, Tablet, or Smart Phone) - for remote system set up and monitoring.

Barcode scanner - for selecting recipe specific to individual product.

PLC, peripheral devices and barcode scanner are 3rd party items.

** For detailed Gateway Module requirements, refer to manual 3A3469 or contact your Graco distributor.*



Unlimited Flexibility in Recipe Set-up

In addition to the 50 pre-configured recipes, ProDispense offers unlimited flexibility with Dynamic Recipe (#99). Here's how it works:

- A barcode reader scans information and communicates it to a programmable logic controller (PLC).
- The PLC goes to a remote server database, finds the proper recipe (specific fluids and volumes, as well as the sequence and time interval between dispenses), and loads it to ProDispense as Dynamic Recipe (#99).
- ProDispense delivers the correct fluid and volume.

For complex applications where the dispense volume and fluid ratios change frequently, you can edit Dynamic Recipe (#99) on your PLC or mobile device.



Ordering information

Build your own system

Select a module

Part number	Description
26A070	The system control module assembly (including 1 advanced display module (ADM), 1 fluid control module [26A134] which controls 2 fluid panels)
26A134	The fluid control module (FCM) expands the base system by 2 fluid panels. Up to 3 modules can be added to each base system. An additional FCM needed only if more than 2 fluid panels need to be controlled

Select a fluid panel*

Part number	26A129	26A131	26A130	26A132	26A165	26A247	26A071
Meter name	Oil meter	Grease/paint meter (G3000 meter)	Water meter	Helical meter	Solvent (S3000 meter)	Coriolis meter	No meter
Application	Oil / lubricant	Grease / paint	Water / antifreeze	High viscosity	Solvent	Sheer sensitive	
Fluid type	10 wt oil to #2 grease	Wide viscosity, high accuracy	Light viscosity, average resolution	Wide viscosity, high accuracy	Light viscosity, high accuracy	Wide viscosity, high accuracy	
Flow rate range	0.95 - 15.2 lpm (0.25 - 4 gpm)	0.076 - 3.8 lpm (0.02 - 1 gpm)	0.95 - 15.2 lpm (0.25 - 4 gpm)	0.15 - 22.7 lpm (0.04 - 6 gpm)	0.05 -1.2 lpm (0.013 - 0.317 gpm)	0.019 - 6.06 lpm (0.005-1.6 gpm)	The end user provides the pulse meter. See manual 3A3469 for operating parameters.
Viscosity	4.1 - 2000 cps	20 - 3000 cps	1 - 20 cps	30 - 1,000,000 cps	20 - 500 cps	20 - 5000 cps	
Accuracy	±1% on dispenses over 500 cc	±1% on dispenses over 12 cc	±1% on dispenses over 2500 cc	±1% on dispenses over 27 cc	±1% on dispenses over 3 cc	±1% on dispenses over 7 cc	
Resolution	4.73 cc/pulse	0.119 cc/pulse	25 cc/pulse	0.273 cc/pulse	0.020 cc/pulse	0.062 cc/pulse	
Working pressure	103 bar (1500 psi)	207 bar (3000 psi)	17 bar (250 psi)	207 bar (3000 psi)	207 bar (3000 psi)	158 bar (2300 psi)	
Porting sizes	Inlet: 1/2" npt(f) Outlet: 1/2" npt(f)	Inlet: 1/4" npt(f) Outlet: 3/8" npt(f) Air inlet: 1/4" npt(f)	Inlet: 1/2" npt(f) Outlet: 1/2" npt(f)	Inlet: 1/4" npt(f) Outlet: 3/8" npt(f) Air inlet: 1/4" npt(f)	Inlet: 1/4" npt(f) Outlet: 3/8" npt(f) Air inlet: 1/4" npt(f)	Inlet: 1/4" npt(f) Outlet: 3/8" npt(f) Air inlet: 1/4" npt(f)	Outlet: 3/8" npt(f) Air inlet: 1/4" npt(f)
Manual	3A3469	3A3469	3A3469	3A3469	3A3469	3A3469	3A3469

*System can be configured for 8 fluid panels

Select accessories (system set up)

Part number	Description
26A133	Remote operator station (remote Start/Stop), includes 50 ft (15 m) of cable
26C266	Wireless Start/Stop module (including transceivers, connecting cables, Start/Stop switch, cable adapter and splitter)
25E765	Hazardous location I.S. power barrier kit - single barrier for the meter only
25B223	Hazardous location I.S. power barrier kit - two barriers, for a meter and solenoid, plus an intrinsically safe solenoid valve
26A243	Upgrade junction box kit upgrades a legacy ProDispense panel to become a new controller
255468	Light tower
26A369	Gateway token kit

Part number	Gateway kits
24W462	ModbusTCP (no gateway token kit needed)
CGMDNO	DeviceNet® *
CGMEPO	EtherNetIP® *
CGMPNO	PROFINET® *

*requires gateway token kit 26A369





ABOUT GRACO

Founded in 1926, Graco is a world leader in fluid handling systems and components. Graco products move, measure, control, dispense and apply a wide range of fluids and viscous materials used in vehicle lubrication, commercial and industrial settings.

The company's success is based on its unwavering commitment to technical excellence, world-class manufacturing and unparalleled customer service. Working closely with qualified distributors, Graco offers systems, products and technology that set the quality standard in a wide range of fluid handling solutions. Graco provides equipment for spray finishing, protective coating, paint circulation, lubrication, and dispensing sealants and adhesives, along with power application equipment for the contractor industry. Graco's ongoing investment in fluid management and control will continue to provide innovative solutions to a diverse global market.

GRACO LOCATIONS

MAILING ADDRESS

P.O. Box 1441
Minneapolis, MN 55440-1441
Tel: 612-623-6000
Fax: 612-623-6777

AMERICAS

MINNESOTA
Worldwide Headquarters
Graco Inc.
88-11th Avenue N.E.
Minneapolis, MN 55413

EUROPE

BELGIUM
European Distribution Center
Graco Distribution BV
Industrieterrein-Oude Bunders
Slakweidestraat 31
3630 Maasmechelen,
Belgium
Tel: 32 89 770 700
Fax: 32 89 770 777

ASIA PACIFIC

AUSTRALIA

Graco Australia Pty Ltd.
Suite 17, 2 Enterprise Drive
Bundoora, Victoria 3083
Australia
Tel: 61 3 9468 8500
Fax: 61 3 9468 8599

CHINA

Graco Fluid Equipment
(Shanghai) Co., Ltd
Building 7, No. 1-2,
Wenshui Road 299
Jing'an District
Shanghai 200436
P.R. China
Tel: 86 512 6260 5711
Fax: 86 21 6495 0077

INDIA

Graco Hong Kong Ltd.
India Liaison Office
Room 432, Augusta Point
Regus Business Centre 53
Golf Course Road
Gurgaon, Haryana
India 122001
Tel: 91 124 435 4208
Fax: 91 124 435 4001

JAPAN

Graco K.K.
1-27-12 Hayabuchi
Tsuzuki-ku,
Yokohama 224-0025,
Japan
Tel: 81 45 593 7300
Fax: 81 45 593 7301

KOREA

Graco Korea Inc.
38, Samsung 1-ro 1-gil
Hwaseong-si,
Gyeonggi-do, 18449
Republic of Korea
Tel: 82 31 8015 0961
Fax: 82 31 613 9801

All written and visual data contained in this document are based on the latest product information available at the time of publication. Graco reserves the right to make changes at any time without notice.

Graco is certified ISO 9001.



Europe
+32 89 770 700
FAX +32 89 770 777
WWW.GRACO.COM